









SCHEDULE OF EQUIPMENT

BOILER	IDEAL ICOS HE 15		
BOILER	RATED OUTPUT 14.7 KW		
Stelrad Compact Radiators & Esprit Towel Rails EN442.			
Room	Temp	Watts	Catalogue
Sitting Room	21	960	K2 450H 700L
Sitting Room	21	588	K1 600H 600L
Kitchen / Breakfast	21	1371	K2 450H 1000L
Kitchen / Breakfast	21	1177K	2 700H 600L
Utility	18	392	K1 600H 400L
Cloaks	18	302	K1 450H 400L
Hall	18	559K	1 700H 500L
Landing	18	392	K1 600H 400L
Bedroom 1	18	529K	1 450H 700L
Bedroom 1	18	529	K1 450H 700L
Bedroom 2	18	529	K1 450H 700L
Bedroom 3	18	529	K1 450H 700L
Bedroom 4	18	454	K1 450H 600L
Bathroom	22	824	1800 x 550 Chrome Straight
En-Suite	22	824	1800 x 550 Chrome Straight

ANCILLARY EQUIPMENT	
CYLINDER	Unvented Cylinder With A Minimum Capacity Of At Least 210 Litres.
PLASTIC PIPEWORK	Pipework & Fittings Polyfit By Polypipe Ltd.
HEATING PUMP	Wilo-Gold 60 Or Equal.
PROGRAMMER	Danfoss FP715 Or Equal.
HEATING ZONE VALVE	Danfoss HP22 Or Equal Heating Zone Valve.
HOT WATER ZONE VALVE	Included With Hot Water Unit.
ROOM THERMOSTAT	Danfoss RMT 230 Or Equal.
T.R.V.s	Pegler Terrier II To Rooms As Listed Below.
T.R.V.s	To All Radiators Except Hall.
RADIATOR VALVES	Pegler Terrier (Chrome) With D.O.C.
INHIBITOR	Suitable Fernox Or Sentinel To Be Added To The Heating System All In Accordance With The Manufacturers Instructions & B.S.7593:1992.
AUTOMATIC BY-PASS VALVE	Danfoss ADVO Or Equal Automatic By-Pass Valve.
PRESSURISATION UNIT	Flamco Cubexpak 8/05 Type B.

STANDARD SYMBOLS & NOTATION

TO ABOVE = T.A.		PIPEWORK IN ROOF SPACE.	FLOW AND RETURN = F&R.
TO BELOW = T.B.		PIPEWORK AT HIGH LEVEL.	HOT WATER SUPPLY = H.W.S.
FROM ABOVE = F.A.		PIPEWORK AT LOW LEVEL.	COLD WATER SUPPLY = C.W.S.
FROM BELOW = F.B.		PIPEWORK BELOW FLOOR LEVEL.	MAINS COLD WATER = M.C.W.S.
PROGRAMMER =			ROOM THERMOSTAT =
			

Ground Floor Heating Layout

NOTES:-

1. The First Metre Of Both The Combined Flow & Return From The Boiler To Be Copper Pipework.
2. All Pipework Drops From The Manifolds Within The First Floor Joist Space To Be 10mm, Except Where Shown, & Behind The Dry Lining.

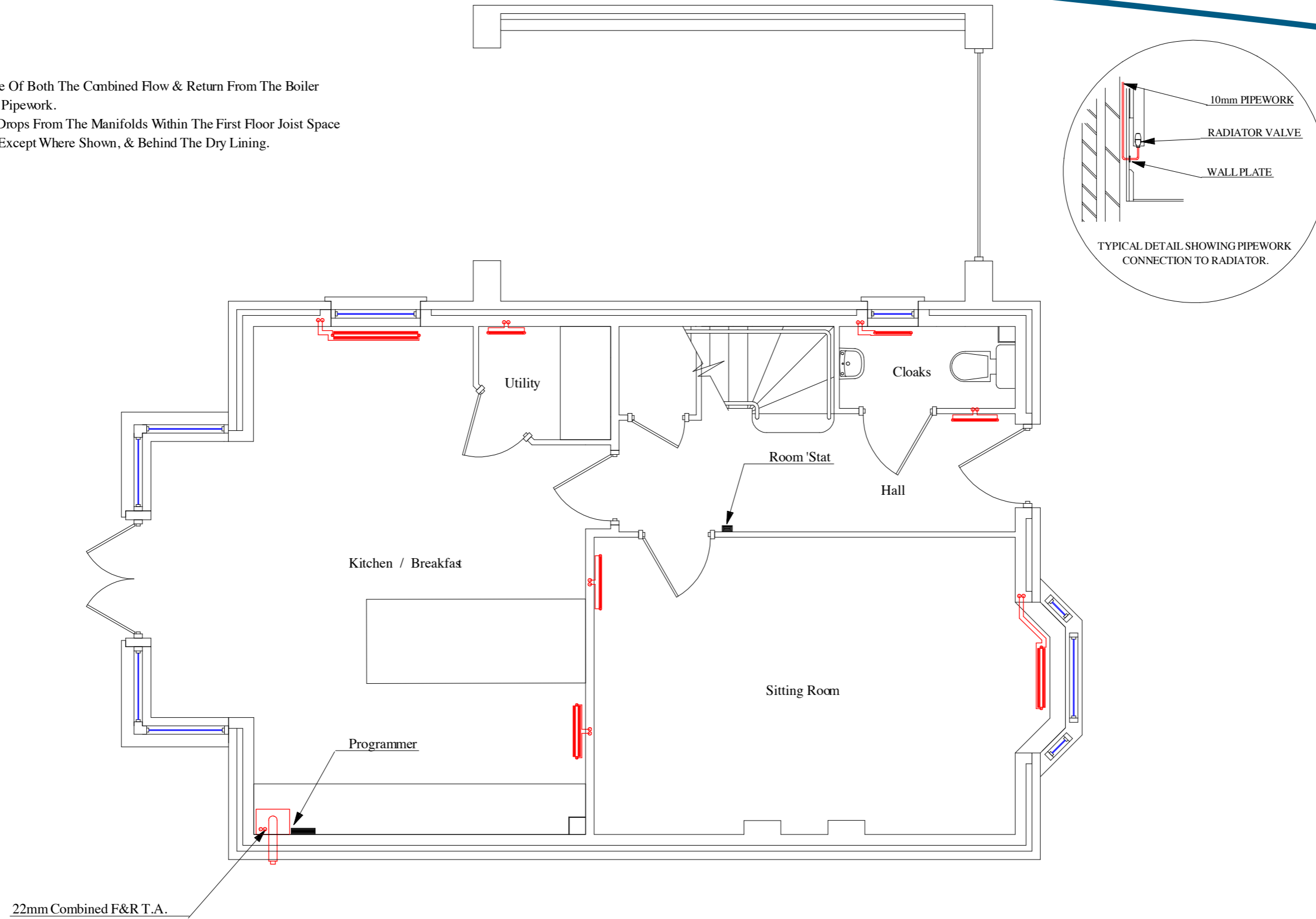

First Floor Heating Layout

NOTE:-

- 1. All Pipework In The Cylinder Cupboard To Be Copper.
- 2. All Pipework Connections To Manifolds To Be 22mm.
- 3. All Pipework From Manifolds To Be 10mm & Behind The Dry Lining.

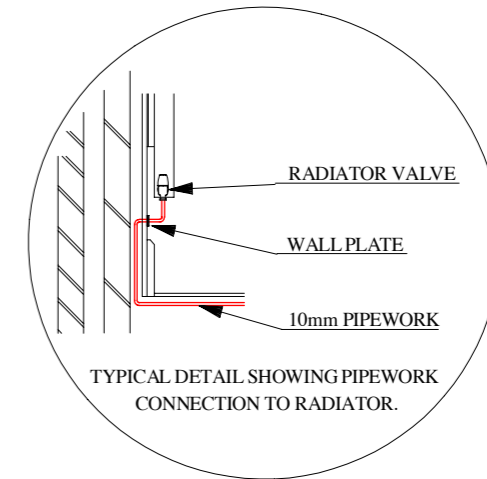
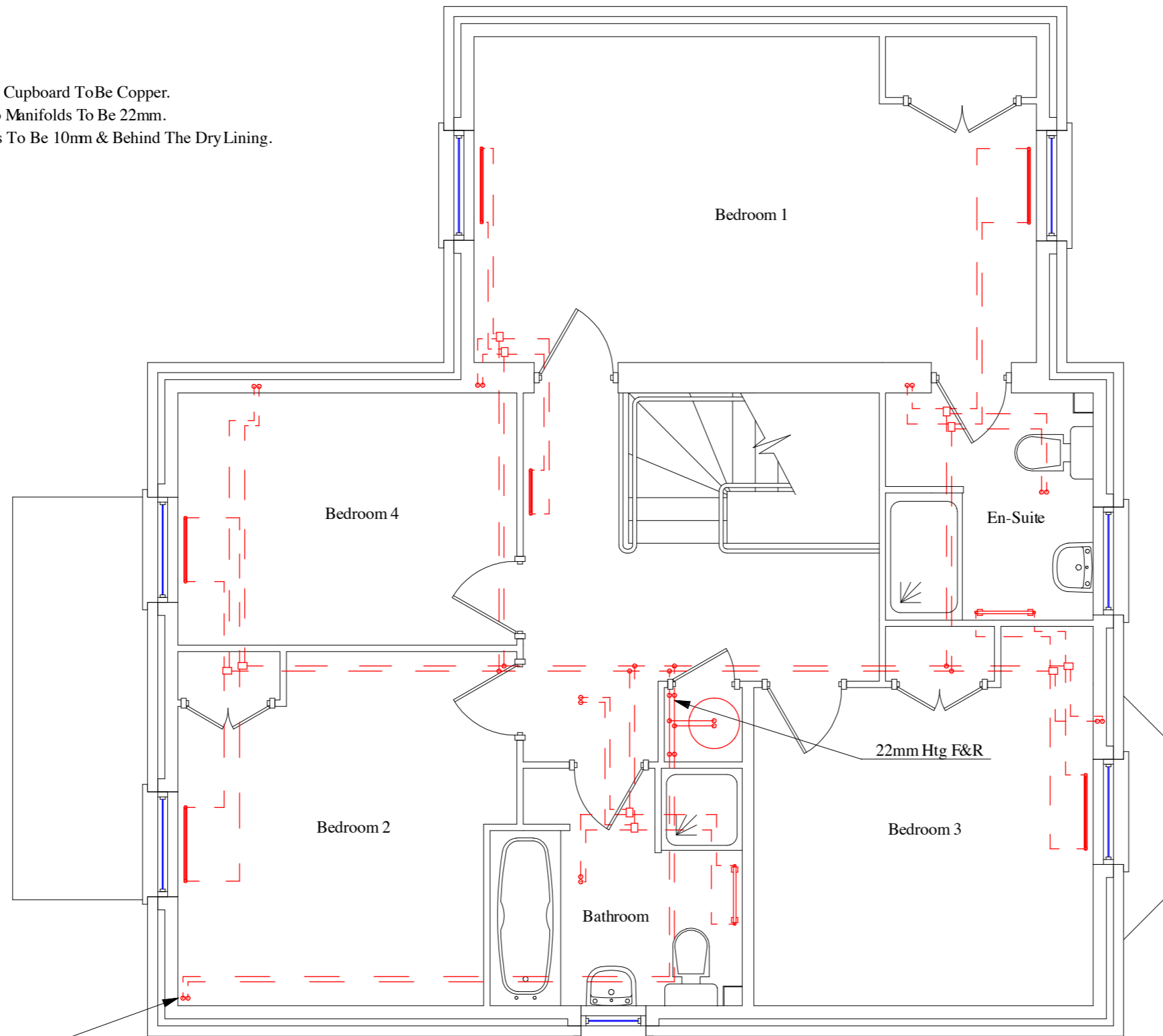

22mm Combined F&R F.B.

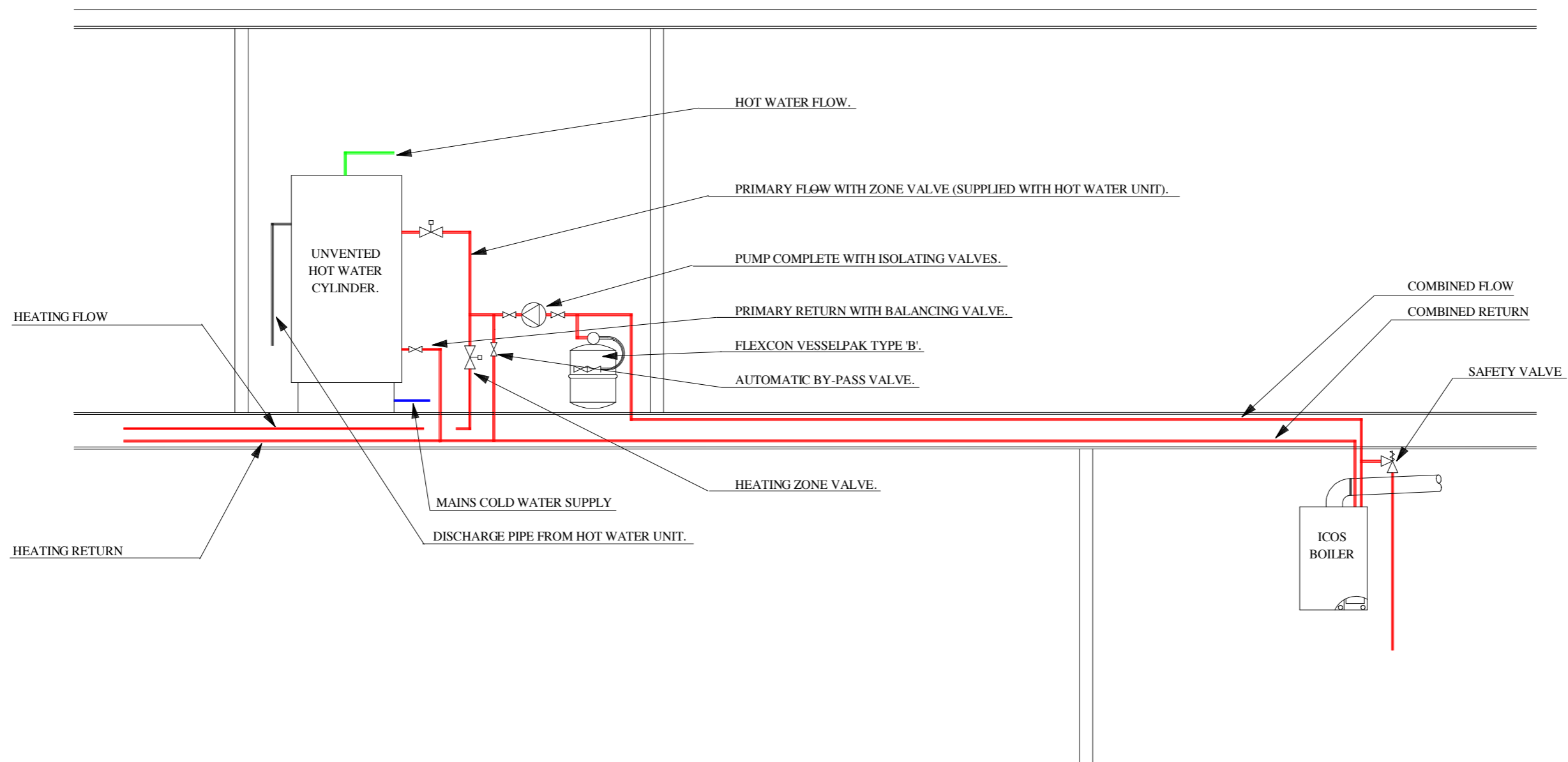

NOTE:-
 THE SAFETY, PRESSURE AND TEMPERATURE RELIEF VALVES ARE INTENDED TO DISCHARGE WATER ONLY UNDER FAULT CONDITIONS; UNDER NORMAL CONDITIONS WATER WILL NOT BE DISCHARGED. IN THE EVENT OF A TEMPERATURE FAULT CONDITION THE DISCHARGE WILL CONSIST OF SCALDING WATER, THEREFORE, IT MUST BE CONVEYED TO WHERE IT IS VISIBLE BUT WILL NOT CAUSE DANGER TO PERSONS OR DAMAGE TO MATERIALS. THIS IS A MANDATORY REQUIREMENT OF PART 3 OF SCHEDULE 1 OF THE BUILDING REGULATIONS 1991.